

DELUXE CROATIAN ISLAND CRUISE



TRIP OVERVIEW

Set sail along one of the most breathtakingly scenic coastlines in the world where rugged mountains cascade down into the crystalline waters. Cruise between peaceful islands and picturesque coastal cities, whilst making stops at historic Korcula, reputedly the birth place of the legendary explorer Marco Polo, lavender-scented Hvar and the idyllic forest covered isle of Mljet. On shore guest will have time on their own to explore the many fascinating sites within these enchanting locations.

ITINERARY & DETAILS

This document aims to give you all the information that you require for a smooth and comfortable trip on your Croatian Island Cruise. Please take the time to read this dossier to familiarise yourself with all the aspects of our tour. It includes important information such as flight details, visa requirements and travel insurance.

Your included meal guide:

B = Breakfast, L = Lunch, D = Dinner

DAY 1: UK to Trogir

Depart London on your direct flight to Split, where you will be transferred to your boat, docked in the port of Trogir, for the night. This afternoon* spend time exploring the UNESCO World Heritage Site of Diocletian's Palace, built by the Roman emperor Diocletian as a fortress in the 4th century. It now forms the centre of a bustling city.

DAY 2: Trogir to Hvar Island B/L

Head for the island of Hvar, known to be the longest and sunniest Croatian island and a favourite with sailors for over two thousand years. Weather permitting, the cruise will stop en route for a relaxing swim off island Solta, a secluded cove, before arriving at the island's hub, Hvar Town. Spend your evening sampling its hip but laid-back restaurant scene.

DAY 3: Hvar Island to Mljet National Park B/L/D

A highlight of the cruise, Mljet is known as Croatia's greenest island with the national park making up almost one third of the landmass. After lunch, take a local ferry to Islet Melita, a charming island in the middle of the Large Lake, to visit the former Benedictine monastery. This evening, be a guest of your captain and enjoy a three-course meal on board your vessel.

DAY 4: Mljet National Park to Dubrovnik B/L

Journey south this morning, stopping for a swimming break at the Elafiti Islands. This afternoon, arrive in the port of the UNESCO-listed city of Dubrovnik, known as the 'Pearl of the Adriatic'. This enchanting seaside city has provided the backdrop to many feature-length films. Explore the Old Town, where all first-time visitors should begin with a walk around the magnificent medieval city walls.

DAY 5: Dubrovnik to Korcula Island B/L

This morning head to Korcula, stopping en route in a bay off the Elafiti Islands for a leisurely swim. After lunch, cruise along to Korcula with time to discover the town and acclaimed birthplace of the explorer Marco Polo. With an impressive old fortress and quaint cobbled streets, Korcula is an idyllic place to spend the evening.

DAY 6: Korcula Island to Brač Island B/L

Set sail along the crystal blue waters for Brač Island, stopping in one of the beautiful secluded bays of this area for swimming and sunbathing. The island landscape of Brač is dominated by a limestone relief, with numerous gullies, crevices, cavities, valleys and coves. Brač is also known for being one of the largest islands in the entire Adriatic Sea.

DAY 7: Brač Island to Trogir B/L

Depart from the island of Brač, stopping for a swim in a bay on the island of Čiovo. Continue to Trogir, a small picturesque town with lot of secrets situated on an island by the Adriatic Sea. Discover the beautiful masterpieces of famous sculptors such as the magnificent Cathedral's portal of master Radovan and the reliefs of master Niccolò di Giovanni Fiorentino. You can find many shops, bars and restaurants throughout this medieval town, a perfect way to spend your final evening before retiring to the boat.

DAY 8: Trogir to UK or extension B

After breakfast on board the boat, disembark and transfer to the airport for your flight back to the UK or continue on to your extension.



ACCOMMODATION DETAILS & MAP

Croatia cruise boat information

Ship information - Deluxe Cruise Yacht

Luxury steel-hull motor yachts offering upscale service, spacious and comfortable cabins with separate beds or queen-size bed and private bath room facilities including a shower stall and a WC. All cabins are equipped with individually controllable air conditioning. Further amenities include a sun deck with deck chairs, a covered lounge area on the upper deck, a comfortable saloon where meals will be served and a bathing platform at the stern. Rooms: hairdryer, deposit box, WIFI, closet, 2 towels per guest, toiletries

Cabins: 20 cabins

Facilities

- Bar ■ Seating area ■ Complimentary WiFi ■ Sundeck ■ Satellite TV
- Air-conditioning ■ Captain's dinner with live music ■ Lounge Area

Please note: the ship listed is provided for guidance only and could be changed at the last minute due to local conditions or for operational purposes. Final confirmation of your cruise will be sent in a document, along with your final flight information, approximately 10 days before you travel.



Meals

Breakfast and lunch each day will be served in the restaurant on the boat. Breakfast served on the boat is hot/continental and lunch is a set three course meal with vegetarian options. As there is a specialist chef on board, all dietary requirements and dislikes should be made known to our reservations staff at the time of booking. One dinner is included, other nights you can discover the great range of restaurants each city has to offer.

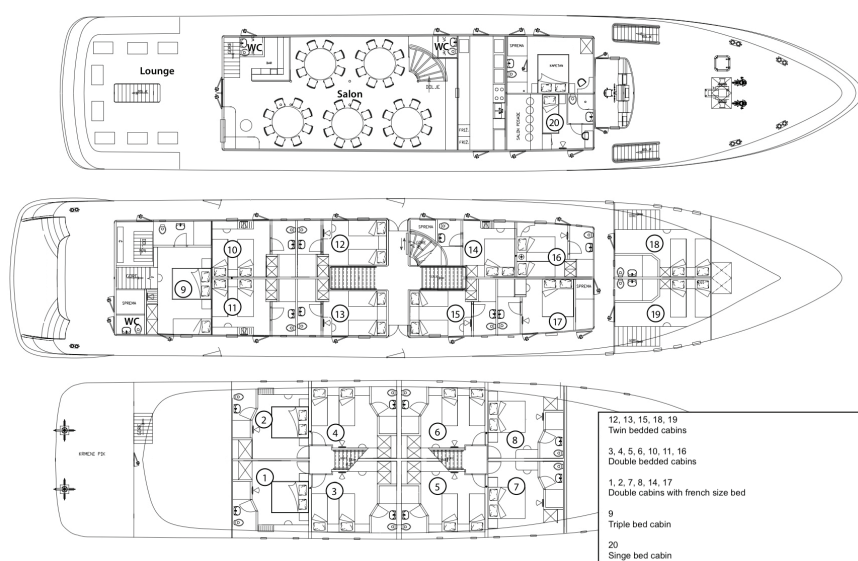

ON YOUR ARRIVAL

On your arrival in Split, you will be met by a representative from our local agent, **Perfecta Travel**, holding a sign displaying: "Mercury Holidays". The Mercury Holidays/Croatian representative will show you to your transfer vehicle. If you need to contact your representative during your stay the details are:

Perfecta Travel

VARSAVSKA 13, 10 000 ZAGREB, CROATIA
Contact Number: +385 21 685 440
Email Address: incoming@perfecta-travel.com

Emergency contact information

Please find below the emergency contact details for Perfecta Travel

Contact in Croatia Telephone number
Mobile: +385 91 266 3205
E-mail: account@perfect-travel.com

WHAT TO PACK

- Warm clothes in case of cold weather
- Insect repellent
- Suncream and a hat with a big brim for sunny days
- Comfortable shoes such as trainers
- Sunglasses and plastic bags
- Towel and swimsuit
- Snorkel, for off shore stops
- Ruck sack or light bag per person
- Personal toiletries and first aid kit
- Travel plug adapter - the electricity supply on board the boat is 220 V. You will need a 2 round pin plug adapter.

WHAT YOU NEED FOR YOUR TOUR

Visas

A visa is not required for your trip to Croatia. Further advice should be sought from the applicable tourist authority for other nationalities and for general queries. We strongly advise you check your destinations' Tourist Board or Embassy for the most up-to-date guidelines regarding passport validity.

Insurance

We strongly recommend that you and all members of your party are suitably insured as soon as you book your holiday. It is a condition of booking that you must have suitable travel insurance. It is important that you purchase travel insurance that suitably covers your participation in whatever activities you may undertake at the time that you make your booking. To assist you with this, we have arranged travel insurance in partnership with Holiday Extras. To arrange your travel insurance with Holiday Extras, please call 0800 781 4237 and quote 'WK830' for preferential rates. Please ensure you provide us with the name of your insurer, policy number and their 24 hour emergency contact number as soon as possible. Mercury Holidays will not be liable for any costs incurred by you due to your failure to take out suitable travel insurance from the date of booking.

Tour Guides

Airport transfers will be with an English-speaking driver and you will have assistance on embarkation and disembarkation. On board the crew speak English as well as other languages and will give information and assistance to all international passengers. For your added reassurance your driver will give you a welcome letter on arrival, containing contact details and the emergency phone number of our local agent Perfecta Travel, should you need it.

Tipping

It is customary to tip approximately £20.00 (200KN) per person for the duration of your cruise. You may tip at the end of the cruise, at check-out. This is shared between all staff members on board the cruise. Tips are accepted in any currency, however it is asked that if you do not tip in the local currency that you only pay in notes as coins cannot be exchanged.

Health and Vaccinations

It is your responsibility to check any health and vaccination requirements applicable to your booked arrangements. We can only provide general information about this. Health and hygiene facilities and disease risks vary from country to country. You should take health advice about your own needs as

early as possible and in good time before your departure. Sources of information include; www.fco.gov.uk, www.travelhealthpro.org.uk, www.hpa.org.uk, your General Practitioner or a specialist clinic.

Physical Accessibility

This tour is accessible to most people with an average level of fitness. It involves some climbing of steep steps, and getting on and off boats. This tour is not suitable for anyone with walking difficulties.

Group Size

The maximum number of passengers on your cruise will be 40 passengers. If in the unlikely event the tour does not go ahead then you may be asked to change to a different date. A full refund will be made available to you should this alternative not be suitable.

Currency Exchange

The currency in Croatia is the Croatian Kuna, We recommend that you exchange your currency before you leave the UK, however cash machines are available in all the major cities to withdraw money in the local currency.

Personal Expenses

You will need to take some extra money with you to cover any dinners where these are not mentioned on your itinerary and personal purchases, such as souvenirs, extra drinks and snacks. Approximately £200-£300 per person will be sufficient for the duration of the tour. Should you wish to pay for any onboard purchases by card, please inform a crew member of this at the beginning of your cruise. **If this is not mentioned, only payment by cash will be accepted.**

IMPORTANT - Embarkation Tax

An embarkation tax of €21 per person must be paid in cash on arrival to your vessel.

Itinerary Changes

The order of events and sightseeing may vary according to local conditions or for operational purposes. For this reason, we have indicated approximate times only. Your local guide will inform you of any schedule changes as they are informed of them. Some road construction and/or weather conditions may lengthen the driving times. Our intention is to adhere to the day-to-day itinerary as printed; however order of events and sightseeing may vary according to local conditions.

FLIGHT INFORMATION

Your flight is to [Split International Airport](#) with [Norwegian Airlines \(D8\)](#), departing from [London Gatwick South Terminal](#).

IMPORTANT: Final flight details will be confirmed on your e-ticket and final documentation which will be sent to you approximately 10 days before departure.

Baggage Allowance

Each passenger is entitled to 20KG of hold luggage plus 1 item of hand luggage not exceeding in size and 1 personal item such as a handbag, briefcase or laptop case. Weight restrictions will be finalized on E-ticket receipt. Should you wish to take additional luggage you will need to pay extra at check-in. Check-In should be at least 3 hours before departure.

Occasionally suitcases can be removed by the airport staff from the baggage carousel and placed in the baggage reclaim office, should you not see your luggage on the carousel, please report to the baggage reclaim office.

Airport Extras

If you wish to arrange Airport car parking or accommodation at preferential rates, we recommend you book this in advance with Holiday Extras - Tel. 0871 360 2000, quoting HX313.

WEATHER AND CLIMATE

Weather can vary quite considerably throughout the year, so please familiarise yourself with the climate charts below.

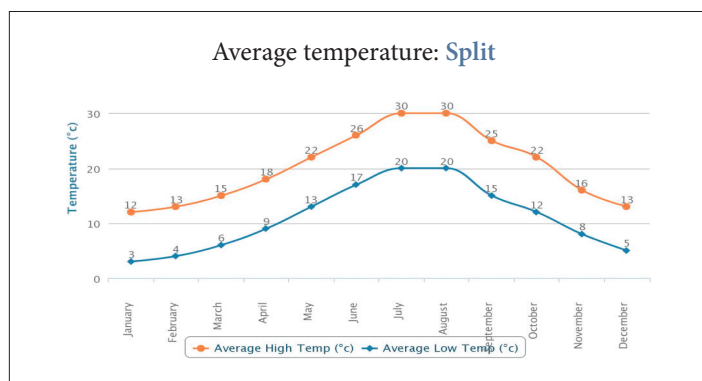
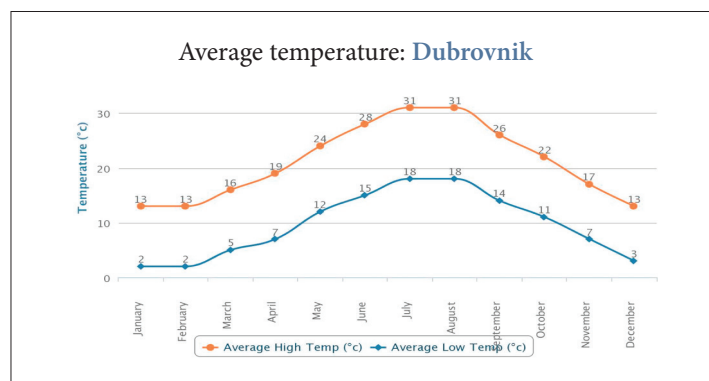

SPLIT BEACH STAY EXTENSION

If you have not yet booked this fabulous extension, there is still time to do so. Please contact 0843 224 0723



TRIP OVERVIEW

Your 4 night stay in Split on the Adriatic Seafront is just a few kilometres from Split's city centre, from here you can explore all that this beach area of Croatia has to offer.

ITINERARY & DETAILS

This document aims to give you all the information which you will require during your extension to Split, Croatia.

Split (4 nights)

The second-largest city in Croatia, Split is a great place to see the real Dalmatian life. This exuberant city has just the right balance of tradition and modernity. Step inside Diocletian's Palace (a UNESCO World Heritage Site and one of the world's most impressive Roman monuments) and you'll see dozens of bars, restaurants and shops thriving amid the atmospheric old walls where Split life has been going on for thousands of years.

Hotel Information

Your stay will take place at either of these hotels:

4★ Radisson Blu Resort Split on Bed & Breakfast.

The Radisson Blu Resort is only steps away from the pebble beaches of the Adriatic coastline as well as only three kilometres away from Split's city centre. Hotel information: Put Trstenika 19, 21000, Split, Croatia. Contact number: 00385 (21) 303030

5★ Le Meridien Lav Split on Bed & Breakfast.

Le Meridien Lav is a five star hotel in Split that features 381 modern rooms, perfect to accommodate a family or a group. The hotel's unique beach front location invites guests to immerse themselves in the inspirational panoramic views of the Adriatic sea.

Hotel information: Grijevacka 2A, Podstrana, 21312, Split, Croatia.

Contact number: 00385 (21) 500500

Any alternative hotels or board basis will have been confirmed at booking. Please speak to our reservations department if you are unsure.

Final confirmation of your hotel will be sent in a document approximately two weeks before you travel.

Personal Expenses

You will need to take money with you to cover any lunches and dinners, as well as personal purchases, such as souvenirs, laundry and drinks.

Tour Guides

Your stay in Split is not escorted by a tour guide and your time will be free to explore the area at your own pace. Transfers are included.

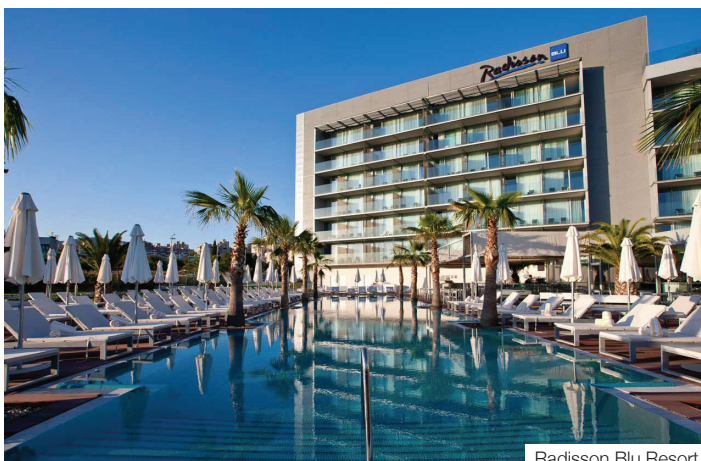

Radisson Blu Resort



Le Meridien Lav

FLIGHT INFORMATION

Please note: Final hotel and flight details will be confirmed on your e-ticket and final documentation which will be sent to you approximately 10 days before departure.

For any further enquiries or for more information call us on **0843 224 0723**

TUCEPI, MAKARSKA BEACH STAY EXTENSION

If you have not yet booked this fabulous extension, there is still time to do so. Please contact 0843 224 0723



TRIP OVERVIEW

Your island adventure comes to an end with a 4 night, 5 day beach extension to Tucepi. A small town located on the Adriatic coast known as the Makarska Riviera.

ITINERARY & DETAILS

This document aims to give you all the information which you will require during your extension to Tucepi, Makarska.

Tucepi, Makarska (4 nights)

Tucepi is located 4 km south-east of Makarska is a popular tourist destination thanks to its glorious coastline. Tucepi's white pebble beaches are edged by pine and olive trees and enjoy a mild climate, due in part to the shelter provided by Mt Biokovo.

Hotel Information

Your stay will take place at the 4★ Bluesun Hotel Alga on Half Board. The Bluesun Hotel Alga is located in Tucepi, one of the most beautiful destinations of the Makarska Riviera. Only a few steps away from the best known beach in Tucepi, the Hotel Alga is ideal for guests who primarily want to have fun, meet new people, enjoy numerous sports activities in the nearby Slatina Sports Centre or go on various excursions.
Hotel information: Dračevica 35, 21325, Tučepi, Croatia.
Contact number: 00385 (2)1601111

Any alternative board basis will have been confirmed at booking. Please speak to our reservations department if you are unsure.

Personal Expenses

You will need to take money with you to cover any lunches, as well as personal purchases, such as souvenirs, laundry and drinks.

Tour Guides

Your stay in Tucepi is not escorted by a tour guide and your time will be free to explore the area at your own pace. Transfers are included.

Please note:

This extension takes place after your main tour.



Bluesun Hotel Alga

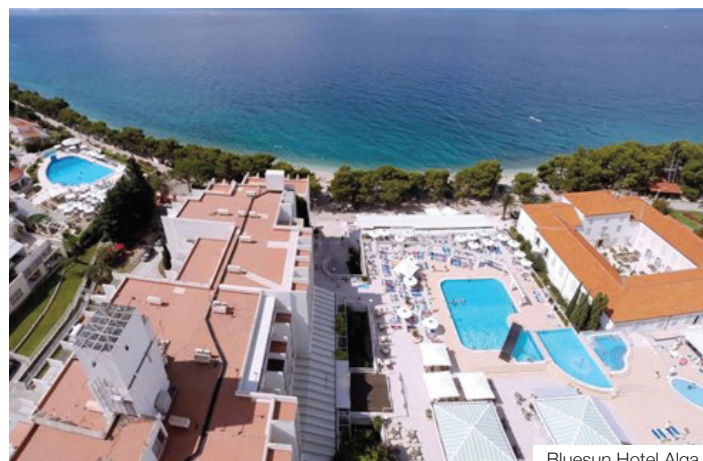

Bluesun Hotel Alga

FLIGHT INFORMATION

Please note: Final hotel and flight details will be confirmed on your e-ticket and final documentation which will be sent to you approximately 10 days before departure.

For any further enquiries or for more information call us on **0843 224 0723**